

## Moe Training Tutorial 13

### Small Premises Three storey – Shop use

1. These plans have been submitted for building control approval for the construction of a new shop. The applicant has submitted a full plans application and a copy of the plans as shown. Is the application valid in this form?
2. What is the statutory control, which allows you to ask for means of escape and warning requirements? (Act, regulations-- section, etc.)
3. What code for means of escape can be used?
4. What structural means of escape requirements are needed?  
What provision for means of warning in the event of fire is needed in accordance with the note below?  
Type a comprehensive schedule of items that would apply to this application in respect to the requirements of Approved Document Part B and the appropriate British Standards.

**Note:** - Copy the plans and mark up your observations on the plans.

Clearly identify the locations of the following items and state to what clauses of the Approved Document and BS they should conform to~

- 1) Smoke detectors and the associated equipment required for the fire alarm system.
  - 2) Escape lighting.
  - 3) Fire doors.
  - 4) Fire signage.
5. The applicant has stated in a letter with the application that a travel distance of 27m to a single exit is acceptable. However your Manager has informed you that the maximum distance in one direction is 18m. Who is correct?
  6. Produce the appropriate letters and forms to fully complement this application addressed to the applicant and any other parties that may need to be consulted.
  7. What should be the minimum width of the stairway and exit doors?
  8. Would this shop require any additional provisions for escape of disabled people?

If additional provisions for disabled people were required what would they be?

A manual form of fire warning will be provided by the manager or in the absence of the manager, the manager's deputy, shouting the word FIRE in accordance with item 1.28 of Approved Document B 2006.



= Display unit 1.2m high.

Usable floor area = 240m<sup>2</sup>

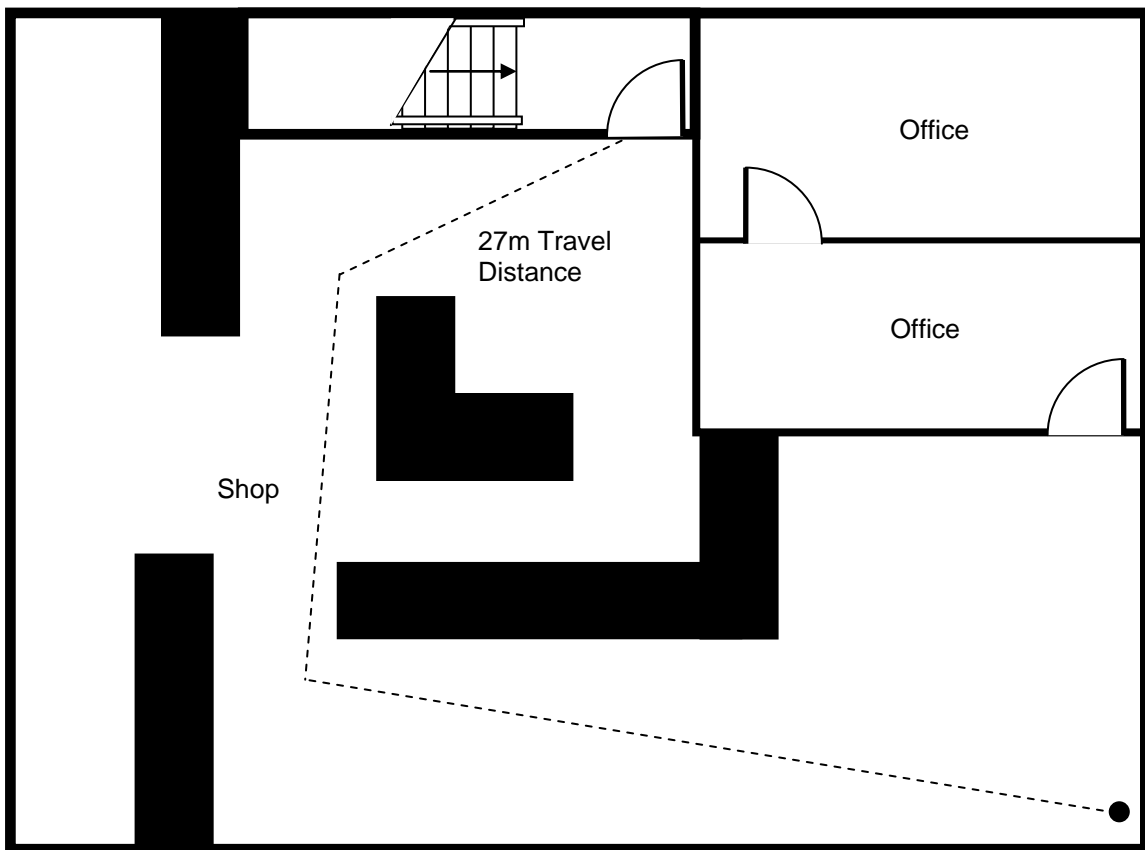

First floor

Occupiable floor area = 265m<sup>2</sup>

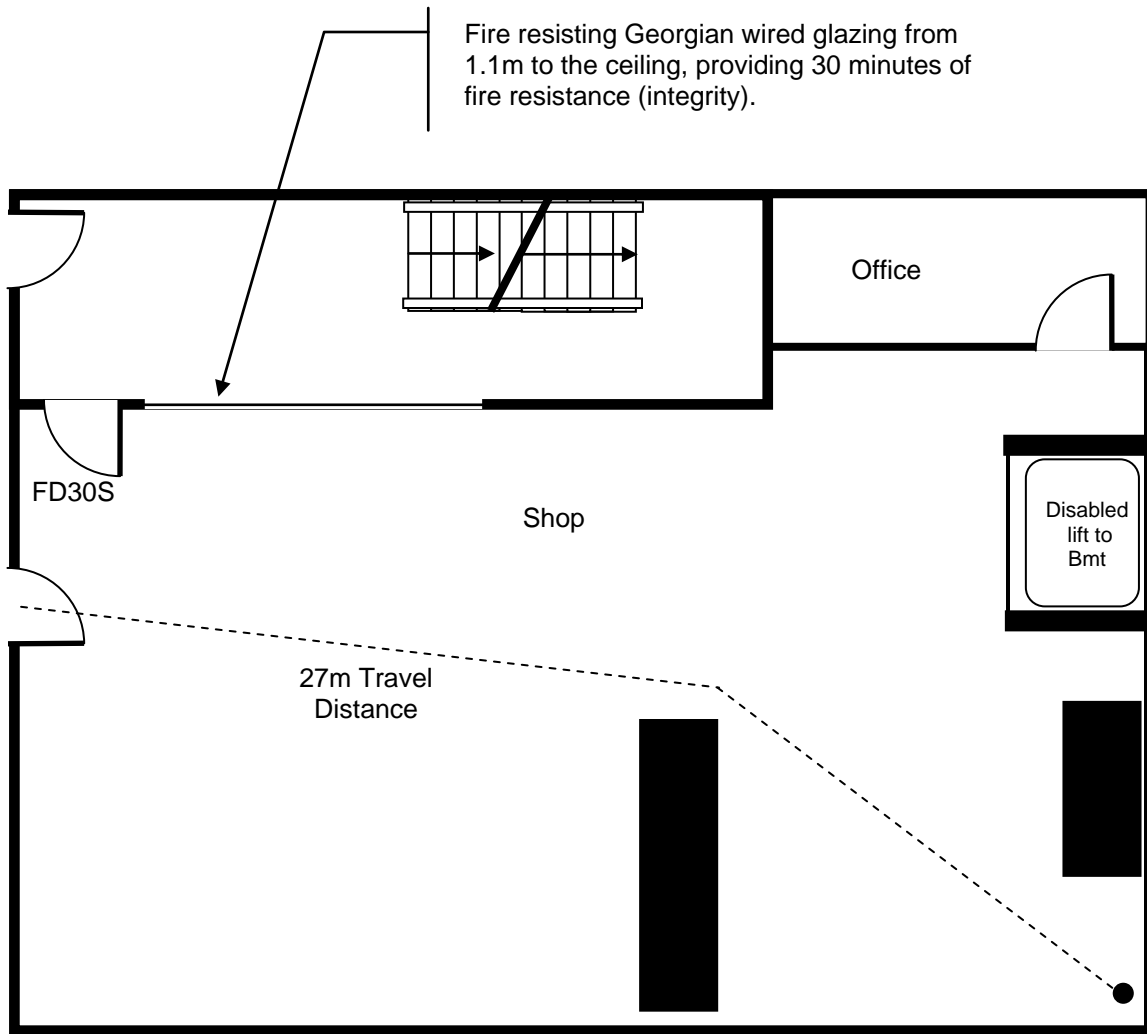

Ground floor

Occupiable floor area = 265m<sup>2</sup>

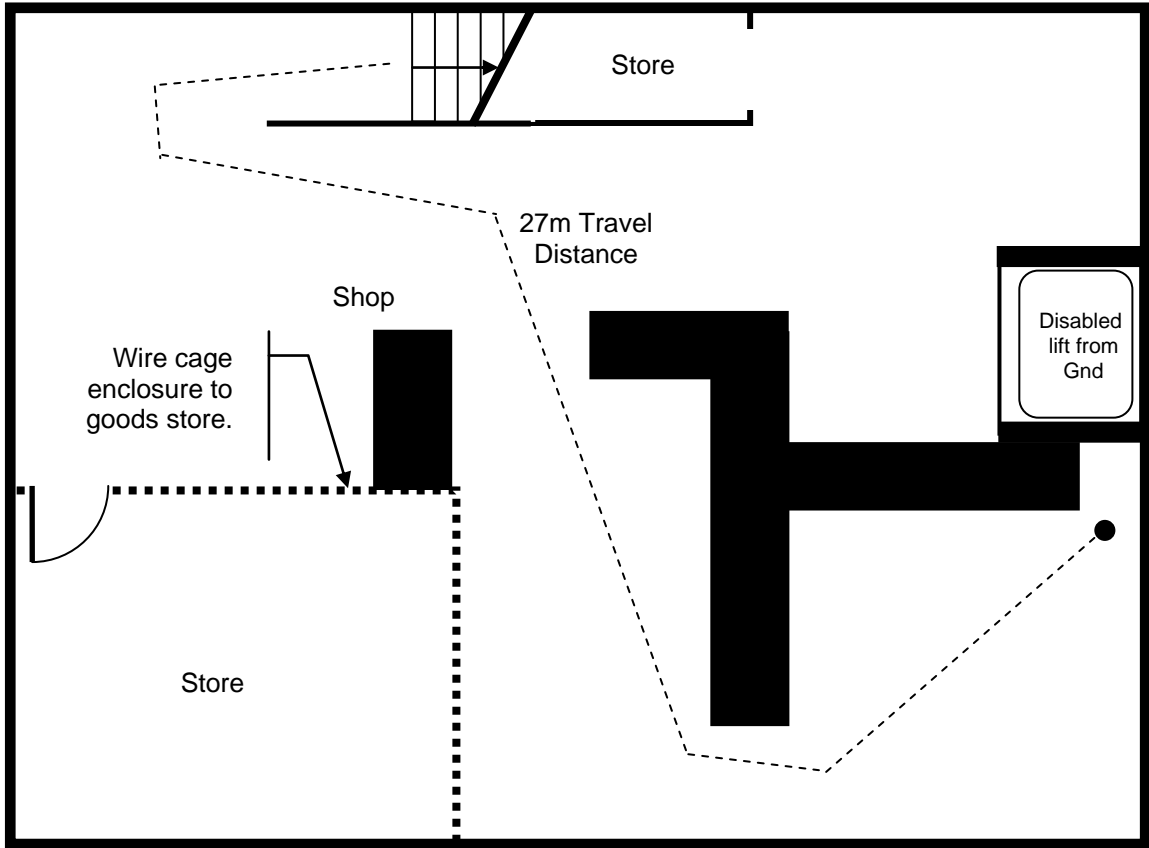

**Basement**