

Moe Training Tutorial 14

New Flats (Four storeys, Third, Second, First, Ground and basement) Services (Gas and Electric)

The services consultants for the new building considered in Tutorial 8 have submitted their proposals shown on the attached plans and described in the attached letter. Answer the following.

Gas

1. Is the Gas pipe located in the protected stairway acceptable? If not what would need to be done?
2. Is the Gas meter acceptable under Approved Document B? If not what would need to be done?
3. Is the Gas meter acceptable under BS 5588: Part 1? If not what would need to be done?
4. Would the gas meter installation as shown on the plans be acceptable in any particular size of new building?
5. Section B-B shows the way in which the 22mm gas pipe has penetrated the wall separating the common stair from the flat, is this acceptable? If not draw a section detailing an acceptable method of forming this service penetration.
6. Section A-A shows the 22mm gas pipe enclosed in a sealed duct, is this acceptable? If not draw what would be acceptable, giving full details.

Electric

7. Is the electric meter acceptable under Approved Document B? If not what would need to be done?
8. Is the Gas meter acceptable under BS 5588: Part 1? If not what would need to be done?
9. Would the proposal in the applicant's letter for the cleaner's cupboard be acceptable?

Show on a copy of the plans the protected routes, which have already been established in your answer to tutorial 8.

Show the protected routes (where required) by using the following to identify the routes: -

- Colour the stairways in **green**
- Common protected lobbies in **blue**
- Protected halls in dwellings in **red**

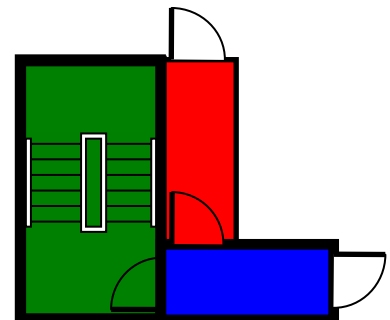



To The Building Control Authority

Dear Sir or Madam,

Please find attached our proposals for the Gas and Electric arrangements in the above premises. I confirm the following:-

It is our intention to comply with the Gas safety (Installation and Use) Regulations and we believe this will be satisfactory for Building Regulations purposes.

Following a discussion with your duty officer we are locating the electric meters to be accessed directly from the single protected stairway to the residential accommodation. However we neglected to mention at the time that we would like to use the electric cupboard as a storage space for cleaner's materials. Would this be acceptable?

Your Sincerely

Ivor G. A. S. Light

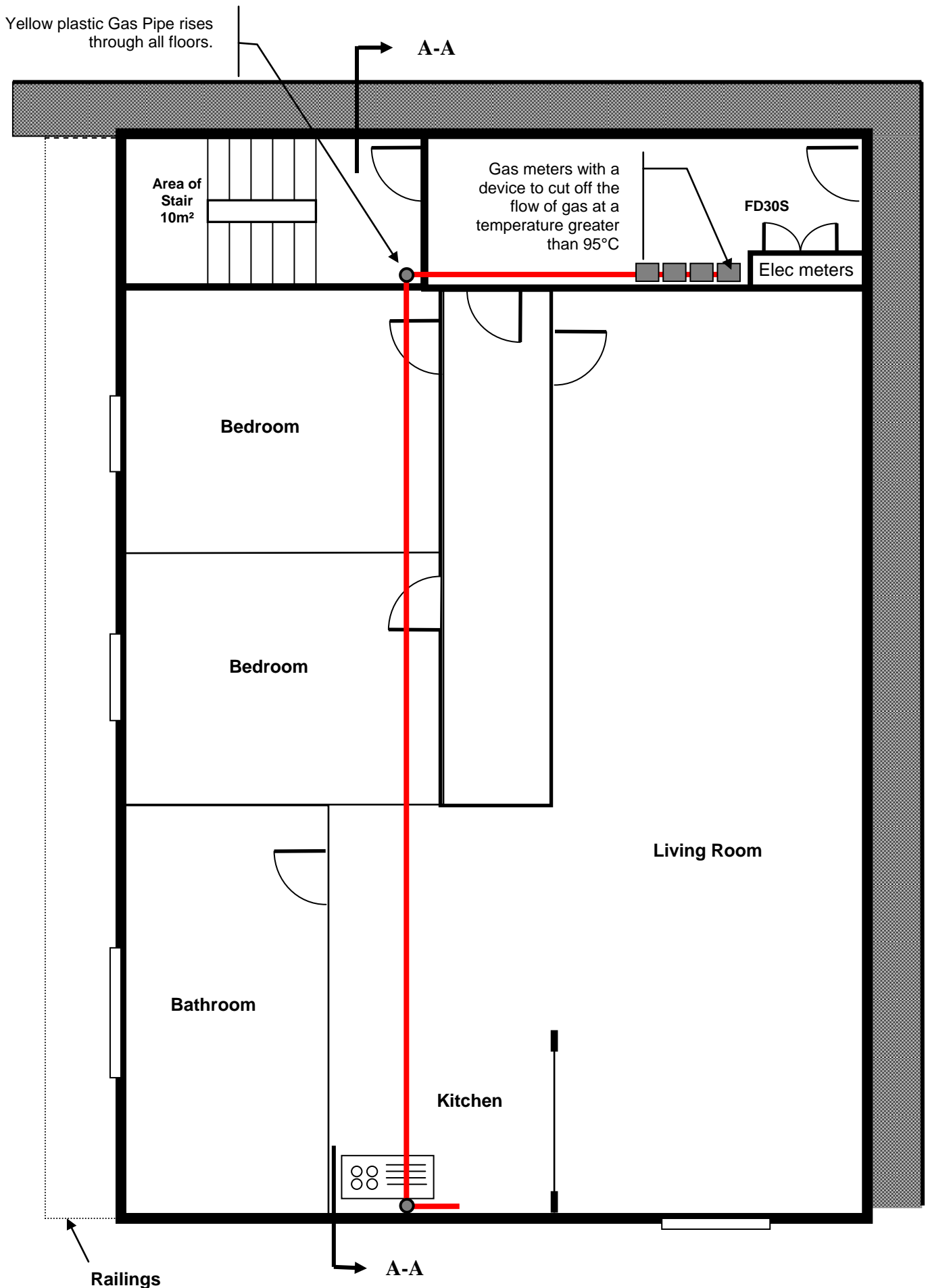

Ground Floor of a new four storey building (G + 1 - 3)

